

5 Star Gas  
STAINLESS STEEL



**AquoMAX**<sup>®</sup>  
Water Heaters

“Giving you more in  
**Hot Water**”



AUSTRALIAN MADE STAINLESS STEEL GAS WATER HEATERS

## STAR PERFORMERS FROM AQUAMAX

AquaMax gas water heaters offer you more than just 5 Star energy efficiency.

With Stainless Steel cylinders across the range they are the preferred choice for homeowners and plumbers alike.

Providing hot water recovery of up to 185 litres per hour, there is an AquaMax model to suit even the largest household.



**G390 SS**

**G340 SS**

**G270 SS**



## OUTSTANDING FEATURES

### **5 STAR ENERGY EFFICIENCY**

to help you save on energy bills

### **STAINLESS STEEL CYLINDERS**

can resist corrosion for longer than conventional enamelled steel cylinders<sup>3</sup>

### **10 YEAR CYLINDER WARRANTY<sup>1</sup>**

### **HOT WATER RECOVERY FROM 135 TO 185 LITRES AN HOUR<sup>2</sup>**

to have you back in hot water faster, and also handy in times of heavy hot water demand

### **SIGNIFICANTLY LIGHTER**

than traditional enamelled steel cylinder water heaters, which assists in easier installation

### **NO ANODE REQUIRED**

so reducing lifetime service costs

### **INBUILT MIXING VALVE**

on AquaMax G390SS so you can adjust the hot water delivery to as much as 205L in an hour (depending on temperature chosen)\*

\*NOTE: the inbuilt mixing valve is not an approved temperature limiting device. Applications requiring tempering to comply with AS3498 must have a tempering valve installed in accordance with AS3500.4



“Giving you more in  
**Hot Water**”

# AQUAMAX GAS WATER HEATER SPECIFICATIONS

## SPECIFICATIONS

	<b>G390 SS</b> (WITH MIXING VALVE)	<b>G340 SS</b>	<b>G270 SS</b>
Number of people Served	3-6	2-5	2-4
Model	G390SS	G340SS	G270SS
Gas type	Natural	Natural	Natural
Cylinder Capacity	155 Litres	155 Litres	130 Litres
Nominal gas consumption	40 MJ/Hr	40 MJ/Hr	33 MJ/Hr
AGA Star Rating Index	5 Stars	5 Stars	5 Stars
Recovery rate at 45°C rise	185 Litres/Hr <sup>2</sup>	185 Litres/Hr <sup>2</sup>	145 Litres/Hr <sup>2</sup>
Installation type	External only	External only	External only
Pressure & Temperature Relief Valve setting	1400 kPa/99°C	1400 kPa/99°C	1400 kPa/99°C
Max. water supply pressure w/o ECV	1120 kPa	1120 kPa	1120 kPa
Cylinder material	stainless steel	stainless steel	stainless steel
Water inlet connection	Rp 3/4" (20mm) Female	Rp 3/4" (20mm) Female	Rp 3/4" (20mm) Female
Water outlet connection	Rp 3/4" (20mm) Female	Rp 1/2" (15mm) Female	Rp 1/2" (15mm) Female
Gas connection	1/2" flared compression	1/2" flared compression	1/2" flared compression
Warranty (Cylinder) <sup>1</sup>	10 years	10 years	10 years
WaterMark Licence No.	WMKA00200	WMKA00200	WMKA00200
Overall height	1625mm	1635mm	1410mm
Width (approx.)	520mm	520mm	475mm
Depth (approx.)	610mm	610mm	565mm
AGA Approval No.	AGA6114G	AGA6114G	AGA7477G
Weight empty (approx.)	65 kg	65 kg	46 kg

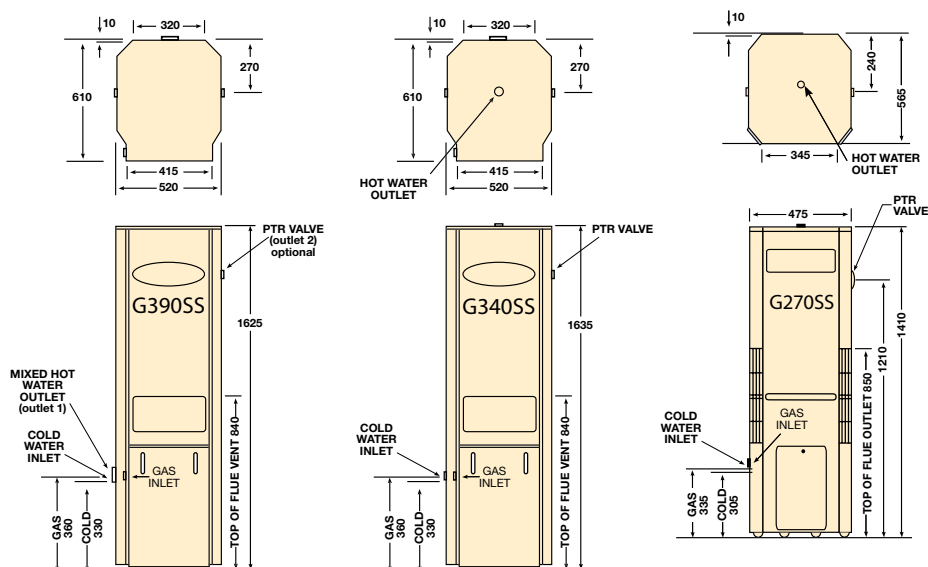

1 Warranty: 10 years parts on cylinder, 1 year parts and labour on cylinder and all other components, when installed in a domestic dwelling. For all other installations, warranty period is one year parts and labour on all components. Conditions apply, see the AquaMax warranty set out in the Owner's Guide and Installation Instructions or view at [www.aquamax.com.au](http://www.aquamax.com.au)

2 Based on cold water temperature of 15°C

3 Note: AquaMax Stainless Steel Water Heaters are not recommended for installation in some areas. Refer to the AquaMax website for details of areas not recommended and for which product is not covered by warranty.



**Aquamax Australia Pty Ltd** 463-467 Warrigal Road Moorabbin Vic 3189 Toll Free: 1800 676 000

Ph: (03) 9532 2200 Sales Fax: (03) 9532 5244 Service Fax: (03) 9556 5534

A.B.N. 37 138 189 689

Email: [sales@aquamax.com.au](mailto:sales@aquamax.com.au) For more information visit [www.aquamax.com.au](http://www.aquamax.com.au)

® Registered Trademark of AquaMAX Australia Pty Ltd.

© Copyright 2011 AquaMAX Australia Pty Ltd. Neither whole nor part of this publication may be reproduced without permission Part No. AQ0905033-F